

Colours on request (please add RAL code after index number)

Philips / Osram or Tridonic LED module included

2700K, 3000K or 4000K
>80 in standard other on request

Electronic driver in standard, DALI on request

On request

N/A

N/A

-20°C... +40°C

IP65

220-240V/50/60Hz

Direct lighting

Aluminium glossy

Symmetric

Clear glass in standard, frosted on request

5 Years standard warranty

Different lumen output or wattage available on request

All other technical features such as: Luminaires Efficacy

LOR, Lumen maintenance L/B etc. available in our pricelist

Wattage of products may vary due to constant LED efficacy

improvements. Luminous flux & Luminaire Power tolerance

+/- 10%.

System power consumption (LED module & driver) depends on components used

Colour:

LED module:

Colour temperature:

Colour Rendering Index (CRI):

Driver:

Emergency unit:

Movement sensor:

Daylight control sensor:

Operating temperature range:

IP Class:

Power:

Lighting direction:

Reflector type:

Light distribution:

Diffuser:

General data:

Colour:

LED module:

Colour temperature:

Colour Rendering Index (CRI):

Driver:

Emergency

Movement

Daylight control

Operating temperature range:

IP Class:

Power:

Lighting direction:

Reflector type:

Light distribution:

Diffuser:

General data:



Colour temp. [K]	CRI	Lifetime [h]	Warranty [Years]	MacAdam [SDCM]	Weight [kg]
2700	Ra > 80	50.000	5	3	0,30
3000	Ra > 80	50.000	5	3	0,30
4000	Ra > 80	50.000	5	3	0,30

Index no.	Lumen output [lm]	Power [W]	Colour temp. [K]	CRI	Lifetime [h]	Warranty [Years]	MacAdam [SDCM]	Weight [kg]
5386.355/827/36D	355	4,6	2700	Ra > 80	15.000	3	4	0,20
5386.370/830/36D	370	4,6	3000	Ra > 80	15.000	3	4	0,20
5386.390/840/36D	390	4,6	4000	Ra > 80	15.000	3	4	0,20

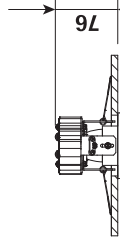



colour.
LED module
Colour tem
Colour Ren
(CRI)
Driver:
Emergency
Movement
Daylight co
Operating
range:
IP Class:
Power:
Lighting di
Reflector t
Light distri
Diffuser:
General da

colours on request (please add RAL code after index number)
Philips / Osram or Tridonic LED module included
2700K, 3000K or 4000K
>80 in standard other on request
Electronic driver in standard, DALI on request
On request
N/A
N/A
-20°C... +40°C
IP65
220-240V/50/60Hz
Direct lighting
Aluminium glossy
Symmetric
Clear glass in standard, frosted on request
5 Years standard warranty
Different lumen output or wattage available on request
All other technical features such as: Luminaire Efficacy LOR, Lumen maintenance L/B etc. available in our pricelist
Wattage of products may vary due to constant LED efficacy improvements. Luminous flux & Luminaire Power tolerance +/- 10%.
System power consumption (LED module & driver) depends on components used

LED module:
Colour temperature:
Colour Rendering Index (CRI):
Driver:
Emergency unit:
Movement sensor:
Daylight control sensor:
Operating temperature range:
IP Class:
Power:
Lighting direction:
Reflector type:
Light distribution:
Diffuser:
General data:



Index no.	Lumen output [lm]	Power [W]	Colour temp. [K]	CRI	Lifetime [H]	Warranty [Years]	MacAdam [SDCM]	Weight [kg]
3206.1100/830	1100	12	3000	Ra > 80	50.000	5	3	2,00
3206.1100/840	1100	12	4000	Ra > 80	50.000	5	3	2,00
3206.2000/830	2000	20	3000	Ra > 80	50.000	5	3	2,00
3206.2000/840	2000	20	4000	Ra > 80	50.000	5	3	2,00
3206.3200/830	3200	31	3000	Ra > 80	50.000	5	3	2,00
3206.3200/840	3200	31	4000	Ra > 80	50.000	5	3	2,00

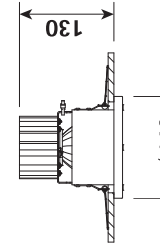



colour.

colours on request (please add RAL code after index number.)

LED module:

Philips / Osram or Tridonic LED module included

Colour temperature:

3000K or 4000K

Colour Rendering Index (CRI)

>80 in standard other on request

Driver:

Electronic driver in standard, DALI on request

Emergency unit:

On request

Movement sensor:

N/A

Daylight control sensor:

N/A

Operating temperature range:

-20°C ... +40°C

IP Class:

IP65

Power:

220-240V 50/60Hz

Lighting direction:

Direct lighting

Reflector type:

Aluminium glossy

Light distribution:

Symmetric

Clear glass in standard, frosted on request

Diffuser:

General data:

5 Years standard warranty

Different lumen output or wattage available on request

All other technical features such as: Luminaire Efficacy LOR, Lumen maintenance L/B etc. available in our pricelist

Wattage of products may vary due to constant LED efficacy improvements. Luminous flux & Luminaire Power tolerance +/- 10%.

System power consumption (LED module & driver) depends on components used



Colour temp. [K]	CRI	Lifetime [h]	Warranty [Years]	MacAdam [SDCM]	Weight [kg]
3000	Ra > 80	50.000	5	3	2,50
4000	Ra > 80	50.000	5	3	2,50
3000	Ra > 80	50.000	5	3	2,50
4000	Ra > 80	50.000	5	3	2,50
3000	Ra > 80	50.000	5	3	2,50
4000	Ra > 80	50.000	5	3	2,50

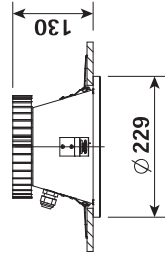
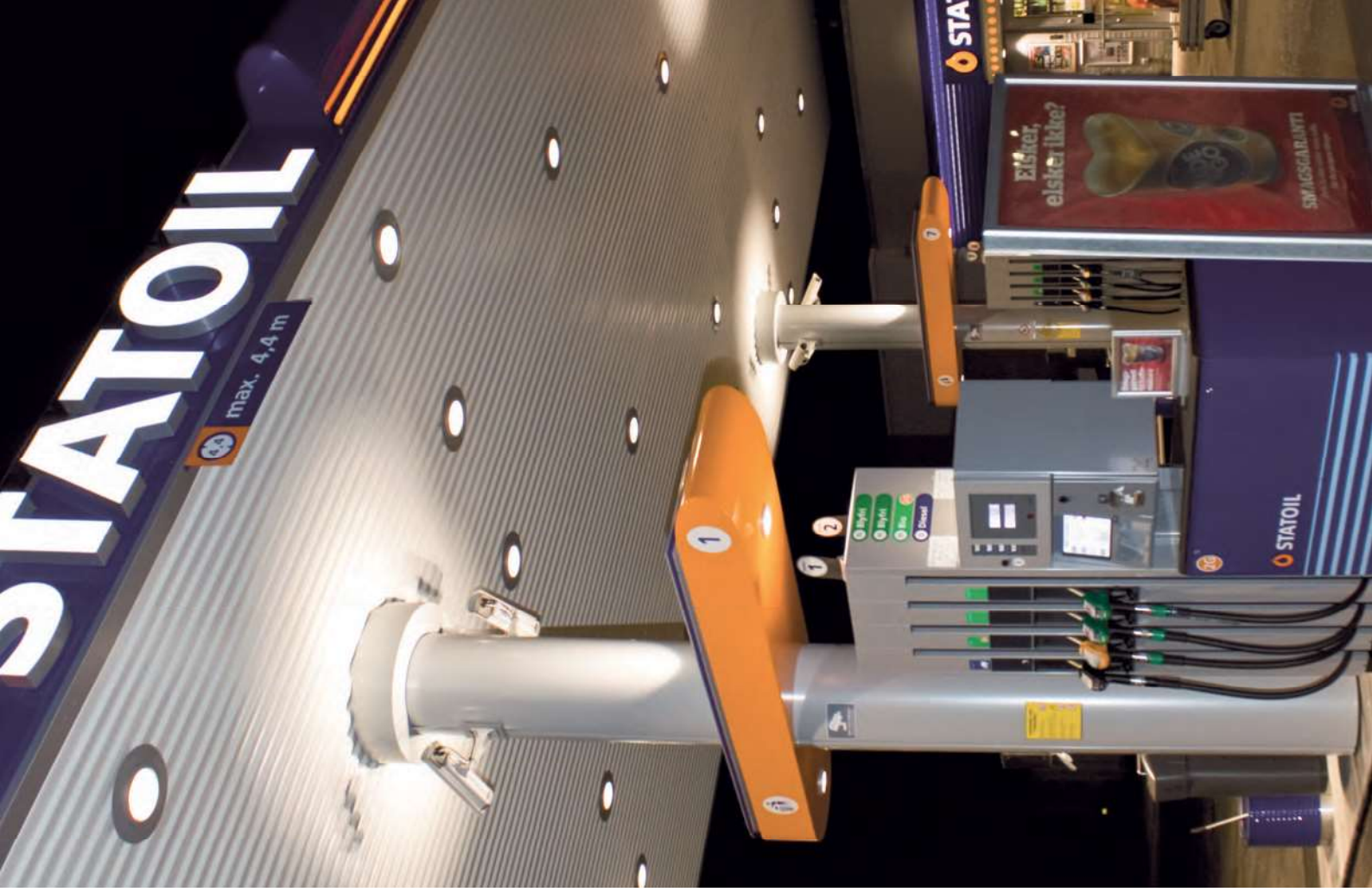

Ø 200

Colour: (please add RAL code after index number.)

LED module: Philips / Osram or Tridonic LED module included
Colour temperature: 3000K or 4000K
Colour Rendering Index (CRI): >80 in standard other on request

Driver: Electronic driver or electronic integrated in standard, DALI on request

Emergency unit: On request

Movement sensor: N/A

Daylight control sensor: N/A

Operating temperature range: -20°C... +40°C

IP Class: IP54

Power: 220-240V/50/60Hz

Lighting direction: Direct lighting

Reflector type: Aluminium glossy

Light distribution: Symmetric

Diffuser: Clear glass in standard, frosted on request

General data: 5 Years standard warranty

Different lumen output or wattage available on request

All other technical features such as: Luminaire Efficacy, LOR, Lumen maintenance L1/B etc. available in our pricelist

Wattage of products may vary due to constant LED efficacy improvements. Luminous flux & Luminaire Power tolerance +/- 10%.

System power consumption (LED module & driver) depends on components used

Colour:

LED module: Philips / Osram or Tridonic LED module included
Colour temperature: 3000K or 4000K
Colour Rendering Index (CRI): >80 in standard other on request

Driver: Electronic driver or electronic integrated in standard, DALI on request

Emergency unit: On request

Movement sensor: N/A

Daylight control sensor: N/A

Operating temperature range: -20°C... +40°C

IP Class: IP54

Power: 220-240V/50/60Hz

Lighting direction: Direct lighting

Reflector type: Aluminium glossy

Light distribution: Symmetric

Diffuser: Clear glass in standard, frosted on request

General data: 5 Years standard warranty

Different lumen output or wattage available on request

All other technical features such as: Luminaire Efficacy, LOR, Lumen maintenance L1/B etc. available in our pricelist

Wattage of products may vary due to constant LED efficacy improvements. Luminous flux & Luminaire Power tolerance +/- 10%.

System power consumption (LED module & driver) depends on components used



Colour temp. [K] CRI Lifetime [H] Warranty [Years] MacAdam [SDCM] Weight [kg]

3000	Ra > 80	50.000	5	3	2,30
4000	Ra > 80	50.000	5	3	2,30
3000	Ra > 80	50.000	5	3	2,30
4000	Ra > 80	50.000	5	3	2,30
3000	Ra > 80	50.000	5	3	2,60
4000	Ra > 80	50.000	5	3	2,60
3000	Ra > 80	50.000	5	3	2,60
4000	Ra > 80	50.000	5	3	2,60

Index no. Lumen output [lm] Power [W] Colour temp. [K] CRI Lifetime [H] Warranty [Years] MacAdam [SDCM] Weight [kg]

With integrated AC driver

6529.1100/830	1100	10	3000	Ra > 80	50.000	5	3	2,50
6529.1100/840	1100	10	4000	Ra > 80	50.000	5	3	2,50
6529.2000/830	2000	18	3000	Ra > 80	50.000	5	3	2,50
6529.2000/840	2000	18	4000	Ra > 80	50.000	5	3	2,50
6529.3000/830	3000	27	3000	Ra > 80	50.000	5	3	2,50
6529.3000/840	3000	27	4000	Ra > 80	50.000	5	3	2,50
With AC/DC driver								
6617.1100/830	1100	12	3000	Ra > 80	50.000	5	3	2,80
6617.1100/840	1100	12	4000	Ra > 80	50.000	5	3	2,80
6617.2000/830	2000	20	3000	Ra > 80	50.000	5	3	2,80
6617.2000/840	2000	20	4000	Ra > 80	50.000	5	3	2,80
6617.3200/830	3200	31	3000	Ra > 80	50.000	5	3	2,80
6617.3200/840	3200	31	4000	Ra > 80	50.000	5	3	2,80

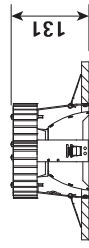

Colour:

Colour: Philips / Osram or Tridonic LED module included

LED module:

Colour temperature:

Colour Rendering Index (CRI):

Driver:

Emergency unit:

Movement sensor:

Daylight control sensor:

Operating temperature range:

IP Class:

Power:

Lighting direction:

Reflector type:

Light distribution:

Diffuser:

General data:

3000K or 4000K

>80 in standard other on request

On request

On request

N/A

N/A

-20°C...+40°C

IP54

220-240V/50/60Hz

Direct lighting

Aluminium white

Symmetric

Mat glass in standard, other on request

5 Years standard warranty

Different lumen output or wattage available on request

All other technical features such as: Luminaire Efficacy LOR, Lumen maintenance L/B etc. available in our pricelist

Wattage of products may vary due to constant LED efficacy improvements. Luminous flux & Luminaire Power tolerance +/- 10%.

System power consumption (LED module & driver) depends on components used



Colour temp. [K]	CRI	Lifetime [h]	Warranty [Years]	MacAdam [SDCM]	Length [mm]	Weight [kg]
3000	Ra > 80	50.000	5	3	1170	5,00
4000	Ra > 80	50.000	5	3	1170	5,00
3000	Ra > 80	50.000	5	3	1450	6,50
4000	Ra > 80	50.000	5	3	1450	6,50

Colour:

LED module

Colour tem

Colour Ren (CRI):

Driver:

Emergency

Movement

Daylight co

Operating range:

IP Class:

Power:

Lighting di

Reflector t

Light distri

Diffuser:

General data



Index no.	Lumen output [lm]	Power [W]	Colour temp. [K]	CRI	Lifetime [h]	Warranty [Years]	MacAdam [SDCM]	Length [mm]	Weight [kg]
5722.4400/830	4400	29	3000	Ra > 80	50.000	5	3	1216	4,50
5722.4400/840	4400	29	4000	Ra > 80	50.000	5	3	1216	4,50
5722.5500/830	5500	36	3000	Ra > 80	50.000	5	3	1500	5,80
5722.5500/840	5500	36	4000	Ra > 80	50.000	5	3	1500	5,80

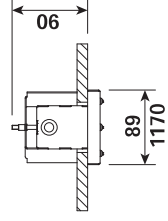

60x1140

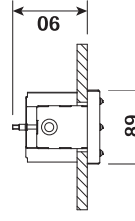

COPENHAG

INDGANG / ENTRANCE

